

Instruction Sheet

Subject: Installations Instructions

Air Tank Retro-fit Kit — P.N. 00212053

Important

Read the following warnings before beginning an installation. Failure to do so may result in possible death or serious injury.

⚠ Warning

To Avoid Serious Injury

- DO** Adhere to all National and Local Plumbing and Electrical Safety Codes.
- DO** Turn "off" incoming electrical service switches when servicing, installing, or repairing equipment.
- DO** Check that all flare fittings on the carbonation tank(s) are tight. This check should be performed with a wrench to ensure a quality seal.
- DO** Inspect pressure on regulators before starting up equipment.
- DO** Protect eyes when working around refrigerants.
- DO** Use caution when handling metal surface edges of all equipment.
- DO** Handle CO₂ cylinders and gauges with care. Secure cylinders properly against abrasion.
- DO** Store CO₂ cylinder(s) in well ventilated areas.
- DO NOT** Throw or drop a CO₂ cylinder. Secure the cylinder(s) in an upright position with a chain.
- DO NOT** Connect the CO₂ cylinder(s) directly to the product container. Doing so will result in an explosion causing possible death or injury. It is best to connect the CO₂ cylinder(s) to a regulator(s).
- DO NOT** Store CO₂ cylinders in temperature above 125°F (51.7°C) near furnaces, radiator or sources of heat.
- DO NOT** Release CO₂ gas from old cylinder.
- DO NOT** Touch refrigeration lines inside units. Some may exceed temperatures of 200°F (93.3°C).

Important

Water pipe connections and fixtures directly connected to a potable water supply shall be sized, installed and maintained in accordance with Federal, State, and Local codes.

⚠ Warning

Danger of Electric Shock

Disconnect and lock out all electrical power sources before performing service or maintenance on this machine — except when electrical tests are being performed by qualified service personnel.

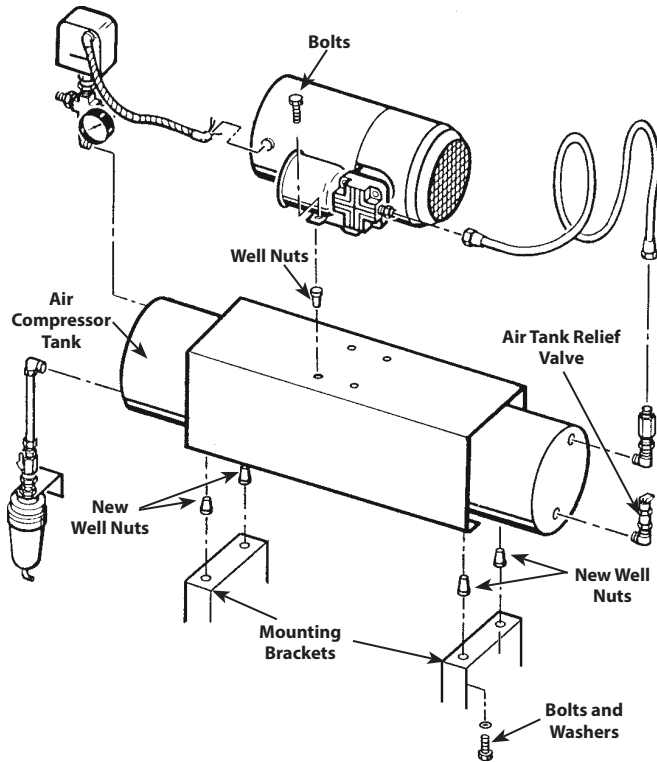

REMOVING OLD TANK

1. Push the switch labeled "Air Compressor" to the "off" position.
2. Open the air tank relief valve. Allow all air pressure to bleed from tank.
3. Remove the four (4) bolts holding the air compressor and motor assembly to the air compressor tank. Save for future step in these instructions.
4. Remove all lines and/or fittings from the old tank. Note the relative position of all fittings removed from the old tank, as they will be re-installed into the new tank in approximately the same position.
5. Remove the four (4) bolts and washers holding the air compressor tank legs to the compressor mounting brackets. Save these for a future step in these instructions.

INSTALLING THE NEW AIR COMPRESSOR TANK

1. Remove and discard the four (4) old well nuts from the stand's air compressor mounting brackets and replace with four (4) new well nuts, provided in kit (refer to figure).
2. Position the new air compressor tank on the mounting bracket. Fasten the tank to the mounting bracket with the four (4) bolts and washers previously removed from the old tank (refer to figure).
3. Install four (4) well nuts, provided in kit, into the holes on top of the air compressor tank's mounting bracket. Fasten the air compressor and motor assembly to the tank bracket with the four (4) bolts previously removed (refer to figure).
4. Attach all lines and fittings to the new stainless steel tank.

NOTE: Use Teflon tape on all fittings. Failure to use Teflon tape on all fittings will cause tank to leak.

START-UP

1. Push the switch labeled "Air Compressor" to the on position. The compressor motor should begin to run and will cycle "off" when the tank pressure reaches 85 psi (5.9 bar). If not, use instructions inside lid of pressure switch to adjust to proper settings.
2. When compressor cycles "off", check all connections for leaks.