

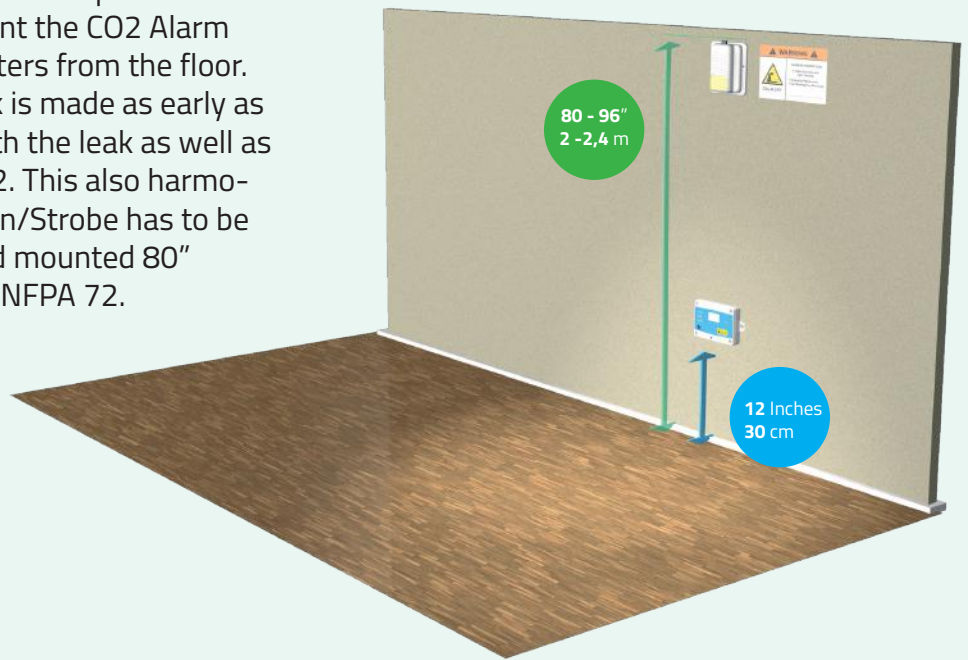

# CO2 Alarm Sensor Mk9 Quick Guide

## Installation Height

CO2 is a heavy gas that accumulates in the lowest areas filling an area from the floor and up. Therefore it is our recommendation to mount the CO2 Alarm Sensor at 12 inches /30 centimeters from the floor. This way the awareness of a leak is made as early as possible insuring time to deal with the leak as well as avoiding unnecessary loss of CO2. This also harmonizes with existing code. The Horn/Strobe has to be able to be seen by everybody and mounted 80" to 96" above the floor as per the NFPA 72.



## CO2 detection distance

The CO2 Alarm Sensor must be mounted within a 5 meter/ 15 feet radius of the CO2 distribution point. If a specific distribution point cannot be defined, install the sensor in the most appropriate location to cover a 78 square meter / 840 square foot area to be monitored.



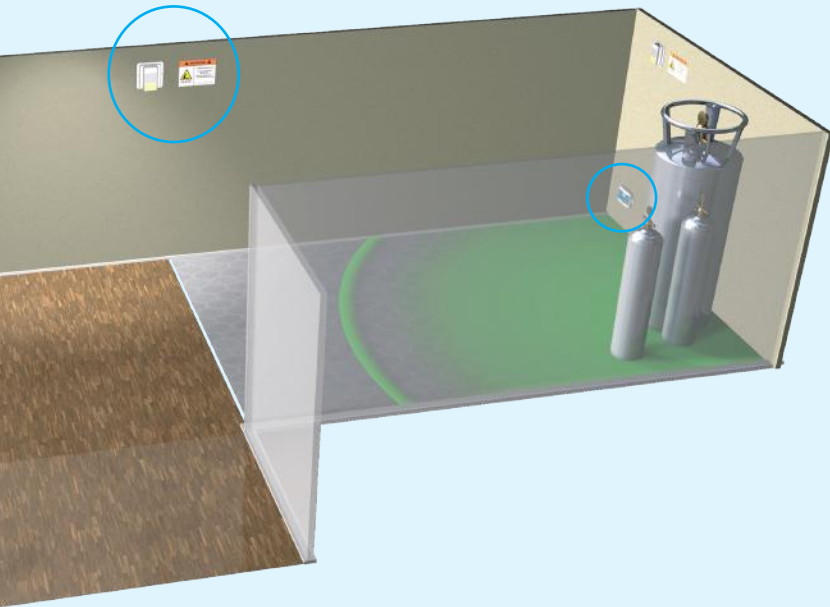

## ↔ Corridors

In areas where the CO2 is stored in the end of a corridor, it is paramount to place an extra Horn Strobe at the entrance of the corridor. This to give early warning in case of a CO2 leakage.

## ⤵ Lower floor/basement

In areas where the CO2 is stored or distributed in Below Grade locations such as Lower Floors and Basements, it is essential to have Horn Strobes before the entrance to the area.

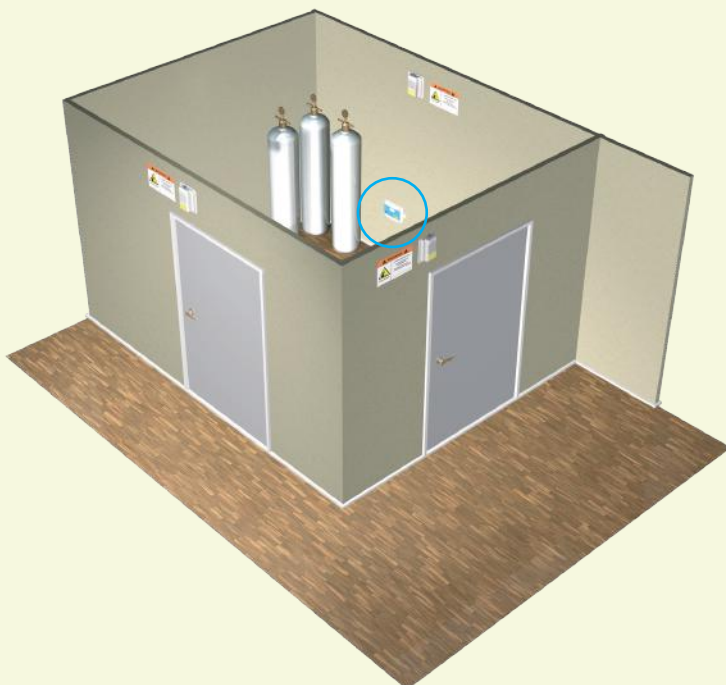
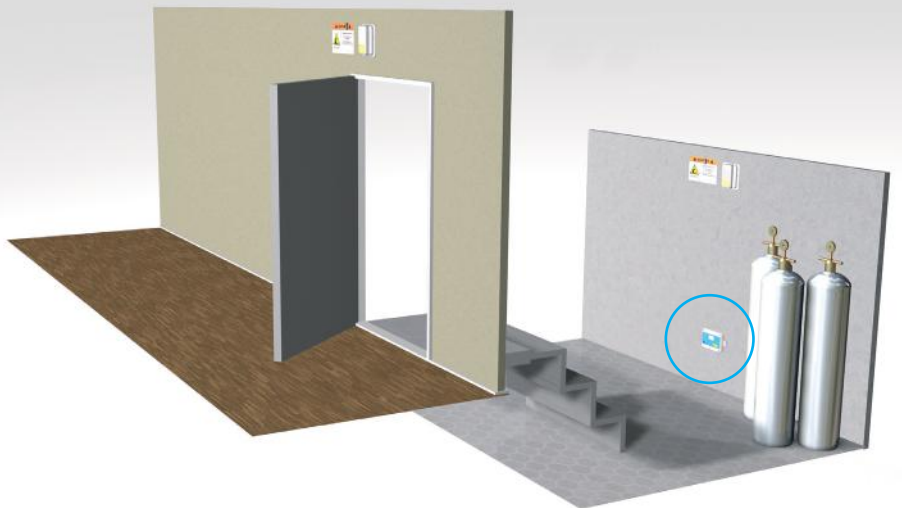

## ◻ Enclosed Spaces

In enclosed spaces Horn Strobes must be placed outside of each entrance.

# System Installation

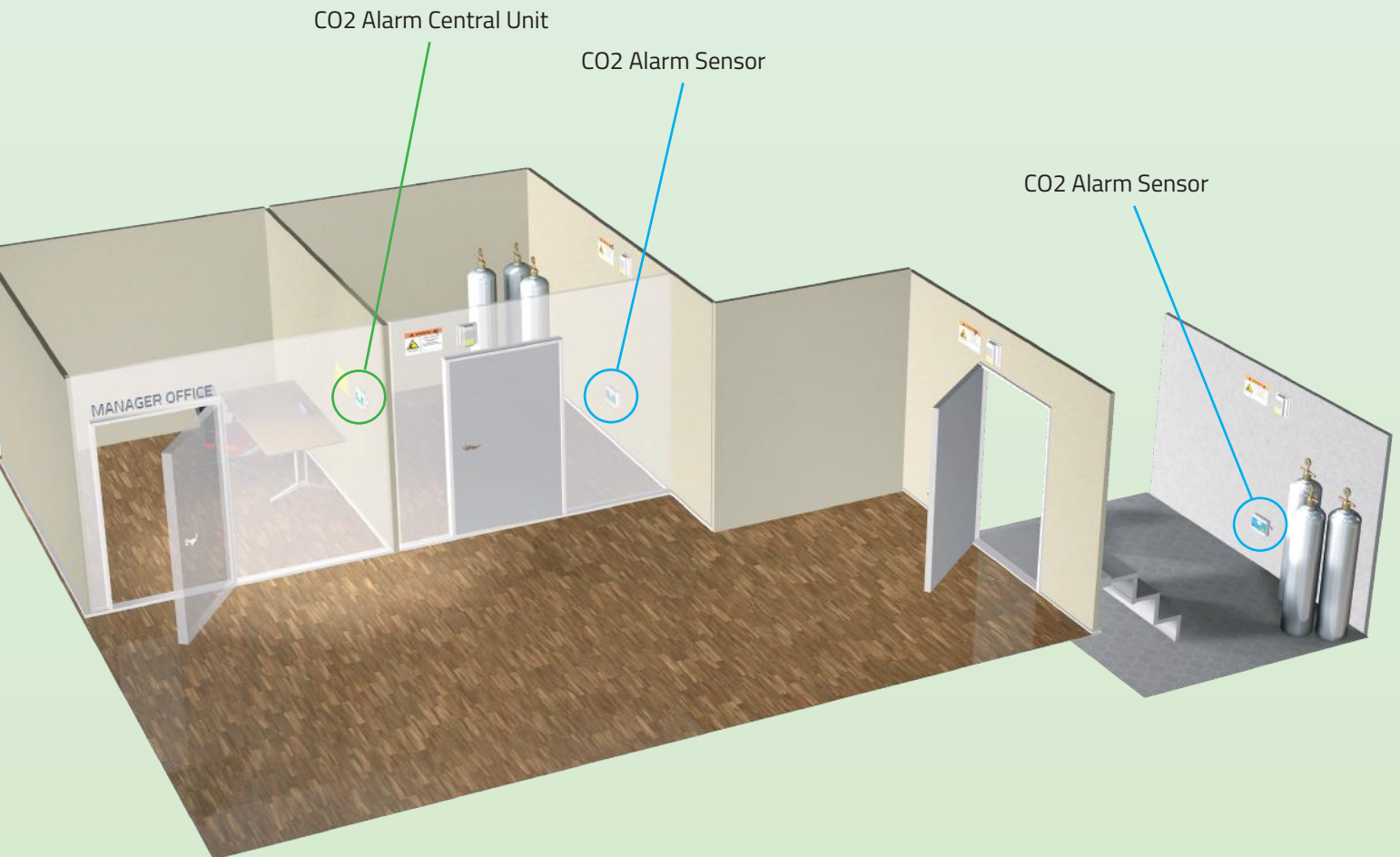

## ⚠ Altitude adjustment

**Important!** For the CO2 sensors to give accurate measurements, do not forget to adjust the altitude compensation on the CO2 sensors to the closest higher altitude value for the location. This easy procedure is covered in the manual.

# Installation Schematics:

